



Vicarage Wood, Harlow, CM20 3HE  
£290,000





# Vicarage Wood, Harlow, CM20 3HE

Offered for sale with no onward chain is this recently redecorated two bedroom terraced house. The property comprises an entrance hall leading to a lounge/diner, kitchen with a range of fitted wall & base level units with work-surface areas, landing, two double bedrooms and a family bathroom with a three piece-suite. Outside the southerly facing rear garden is mostly laid to lawn with a patio and decking area with side access. Vicarage Wood is a popular area located close to The Stow which offers local shops and schools nearby. Chain Free.

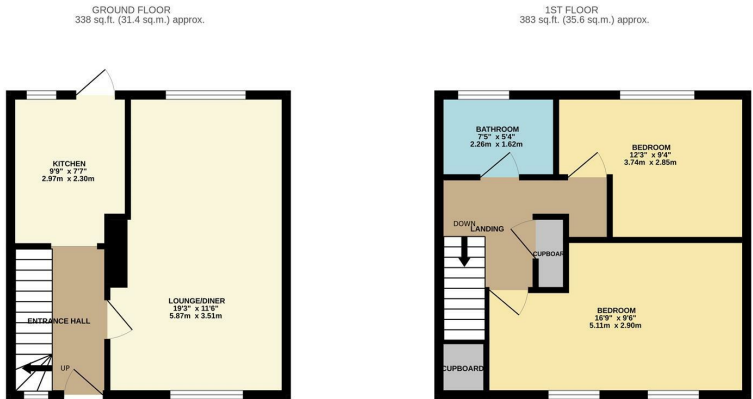

REYLANDJOHNSONVW  
TOTAL FLOOR AREA: 721 sq.ft. (67.0 sq.m.) approx.  
While every attempt has been made to ensure the accuracy of the floorplans contained here, measurements of doors, windows, rooms and any other items are approximate and no responsibility is taken for any error, omission or mis-statement. This plan is for illustrative purposes only and should be used as such by any prospective purchaser. The services, systems and appliances shown have not been tested and no guarantee as to their operability or efficiency can be given.  
Made with Measure (2020)

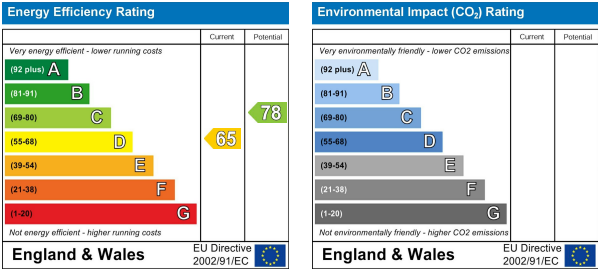

These particulars, whilst believed to be accurate are set out as a general outline only for guidance and do not constitute any part of an offer or contract. Intending purchasers should not rely on them as statements of representation of fact, but must satisfy themselves by inspection or otherwise as to their accuracy. No person in this firms employment has the authority to make or give any representation or warranty in respect of the property.